

REV	DESCRIPTION	DATE
A0	Initial Release	02'.05.10

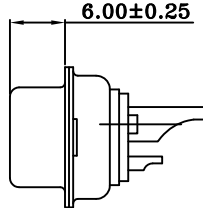
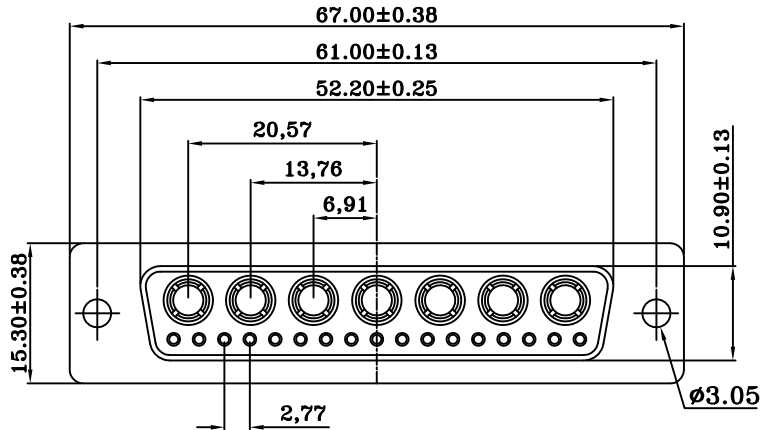

MATERIALS AND FINISH

SHELL : STEEL MATERIAL, TIN FINISHED
CONNECTOR INSULATOR : PBT THERMOPLASTIC,
30% GLASS FILLED, UL 94V-0 RATED, BLACK COLOR
SIGNAL CONTACT MATERIAL: BRASS, FULL GOLD FLASH
HIGH POWER CONTACT MATERIAL: BRASS, 2u" GOLD PLATED

ELECTRICAL CHARACTERISTICS

HIGH POWER CONTACT CURRENT RATING :10,20,OR 40 AMPS
HIGH POWER CONTACT RESISTANCE : 2.7 MILLIOHMS MAX.
DIELECTRIC WITHSTANDING VOLTAGE :
1000 V AC FOR 1 MINUTE
INSULATION RESISTANCE : 5000 MEGAOHMS MIN.
TEMPERATURE RATING : -55°C ~ +125°C

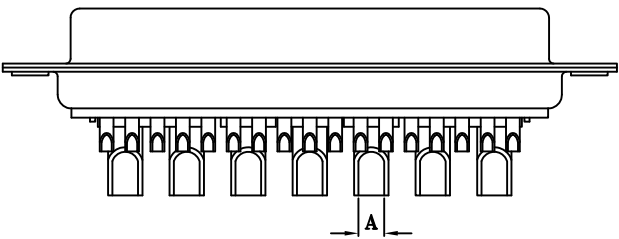

PART NO.	Current Rating	Dimension
		Ø A
DBP-24FCCS-B40	40 AMPS	Ø4.6
DBP-24FCCS-B20	20 AMPS	Ø2.8
DBP-24FCCS-B10	10 AMPS	Ø1.7

Dimensions in mm(Inches)
Tolerances on:
.XX+/-0.13
Angles+/-2°

PANSTRONG COMPANY LTD.				DRAWN BY		TOMMY	
				CHECKED			
TITLE:		D-SUB CONNECOTR (Power Contact Straight Solder Type)		APPROVED			
PART NO:		DBP-247FCCS-Bxx		DRAW NO			
DRAW. BOX NO:							
SCALE	1:1	REV	A0	UNIT	mm		