

REV	DESCRIPTION	APPROVAL	DATE
A	Initial Release		09'.07.16

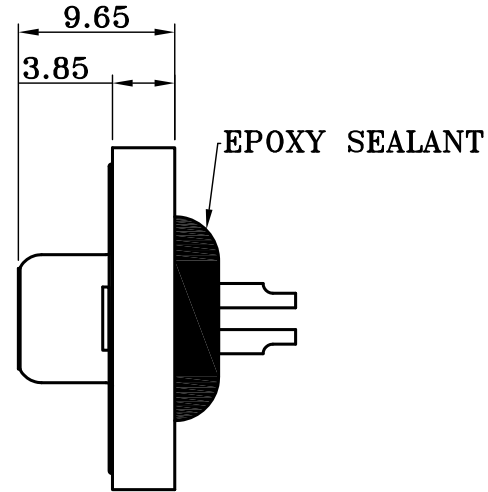
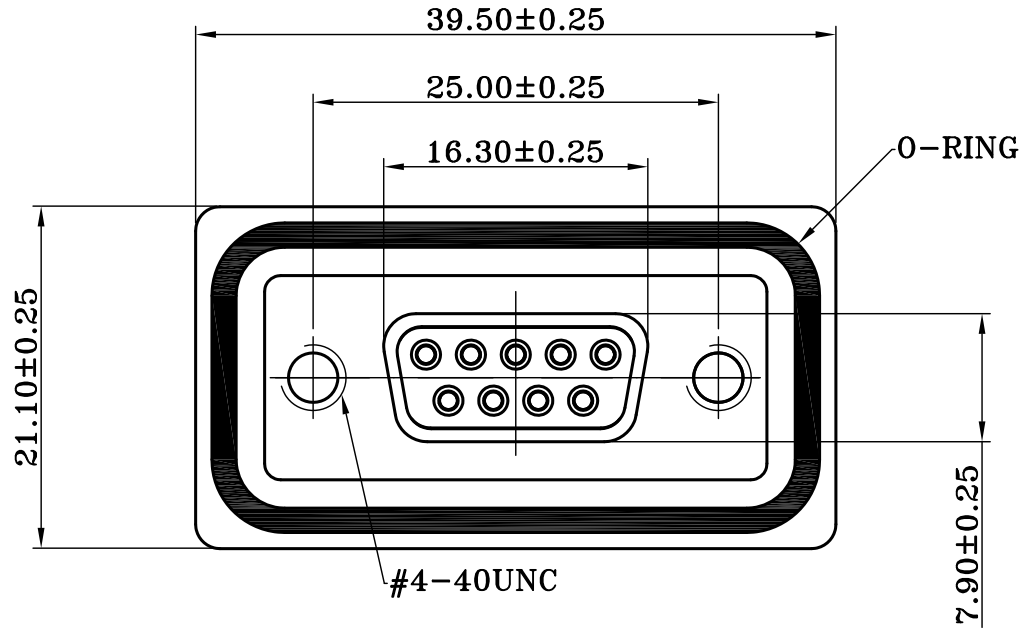

MATERIALS AND FINISH

SHELL : STEEL MATERIAL, TIN FINISHED
 INSULATOR : PBT GF, UL 94V-0 , BLACK COLOR
 SIGNAL CONTACT : COPPER ALLOY, GOLD FLASH
 METAL WATERTIGHT FRAME : PBT GF, UL 94V-0, BLACK COLOR
 O-RING : SILICONE
 EPOXY SEALANT : EPOXY

ELECTRICAL CHARACTERISTICS

SIGNAL CONTACT CURRENT RATING : 5.0 AMPS
 SIGNAL CONTACT RESISTANCE : 10 mΩ MAX.
 DIELECTRIC WITHSTANDING VOLTAGE : 1000 V FOR 1 MINUTE
 INSULATION RESISTANCE : 5GΩ MIN.
 TEMPERATURE RATING : -55°C ~ +105°C
 DEGREE OF PROTECTION : IP67 ACCORDING TO IEC60529

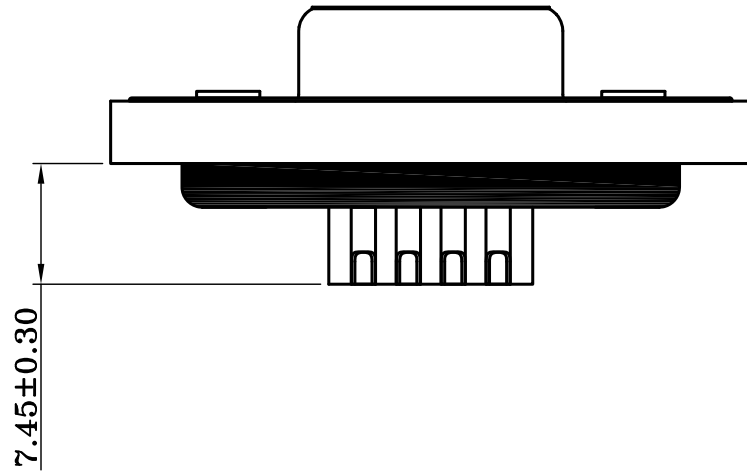

TOLERANCES	
X.	±0.40
.X	±0.30
.XX	±0.20
.XXX	±0.10
X°	±0.30
.X°	±0.20
.XX°	±0.10

 PANSTRONG COMPANY LTD.				DRAWN BY		TOMMY	
				CHECKED			
TITLE:				APPROVED			
PART NO:				DB09FWP11KG			
File Number:				DRAW NO			
SCALE		2:1		REV		A	
UNIT		mm		