

REV	DESCRIPTION	DATE
A	Initial Release	05.10.10

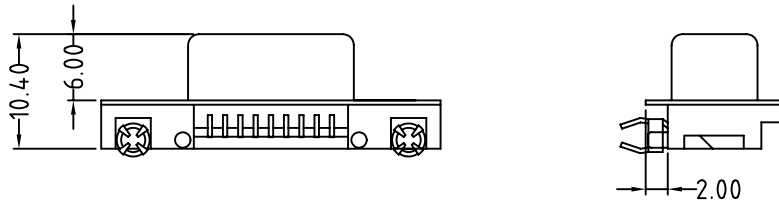

RECOMMEND PCB LAYOUT

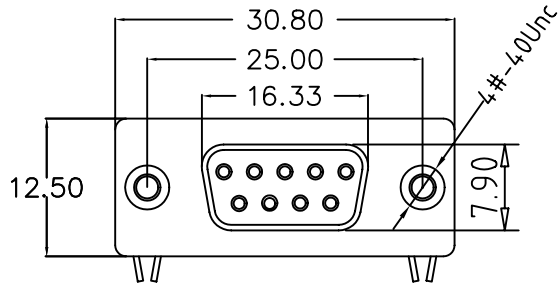
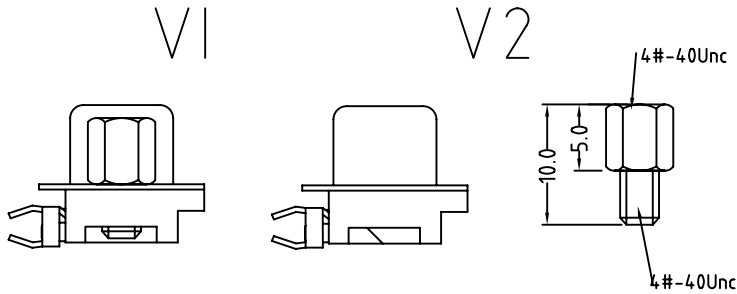
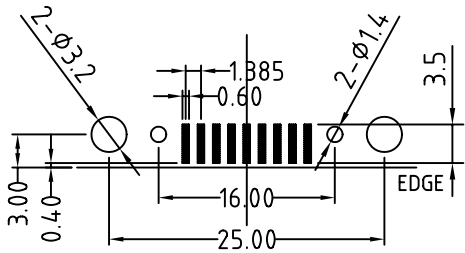

Rohs Compliance

ELECTRICAL CHARACTERISTICS

Contact Current Rating:1Amperes.
 Dielectric Withstanding Voltage:AC 500V at sea level.
 Insulation Resistance:1000Megohms Min.
 Contact Resistance:30Milliohms Max.
 Operation Temperature : -55°C to +105°C.

Material

Contact :Copper Alloy.
 Insulator:LCP. [Select PA6T /PA9T]
 Shell: SPCC.
 Z-Piece: Copper Alloy.

PART NO.

DBNB03-9 x x xx x x x x
 1 2 3 4 5 6 7

- | | |
|---|---|
| <p>1. Connector Type:
 M: Male
 F: Female</p> <p>2. Insulator Color:
 K: Black G: Green B: Blue</p> <p>3. Contact Plating:
 00: Flash Gold
 0A: 15u" Selective Gold
 0B: 30u" Selective Gold</p> <p>4. Shell Plating:
 N: Nickel T: Tin</p> | <p>5. Board Mounting Option:
 1: Fork 2 Pins Board Lock
 2: Fork 3 Pins Board Lock
 3: Fork 4 Pins Board Lock</p> <p>6. Accessory Options:
 0: #4-40 Thread Hole, without Screws
 1: #4-40 Thread Hole, with Fixed Screws(5.0x10.0)
 2: #4-40 Thread Hole, with screws(5.0x10.0)</p> <p>7. Insulator Material:
 Blank: Standard PBT
 H: High Temp. PA9T</p> |
|---|---|

TOLERANCE UNSPECIFIED
 X ±0.30 Ang ±2°
 XX ±0.25
 XXX ±0.150

PANSTRONG COMPANY LTD.				DRAWN BY		TOMMY				
				CHECKED						
TITLE:		Slim D-SUB Connector 9P Female, Low Profile SMT Type				APPROVED				
PART NO:		DBNB03-9F Series				DRAWING NO.				
SCALE		/		REV	A		UNIT	mm		