

REV.	DESCRIPTION	DATE
A1	Initial Release	06.08.23

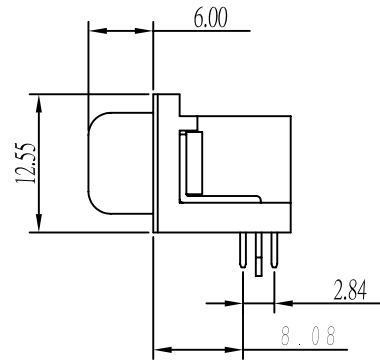
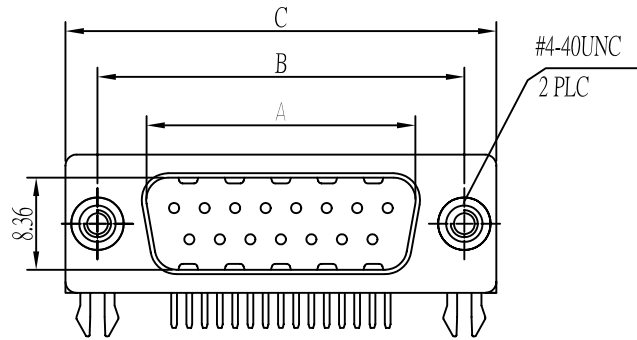

ELECTRICAL CHARACTERISTICS

Contact Current Rating: 3Amperes.
 Dielectric Withstanding Voltage: AC 500V/60sec. r.m.s.
 Insulation Resistance: 1000Megohms Minimum. at DC 500V.
 Contact Resistance: 25 Milliohms Maximum.
 Operating Temperature: -55°C to +105°C

MECHANICAL CHARACTERISTIC

Contact Insertion Force: 341g. Maximum.
 Contact Separation Force: 21g. Minimum.

MATERIALS

Contact: Copper Alloy.
 Insulator: PBT.
 Shell: SPCC
 Z-Piece: Copper Alloy. (or Fe)
 Screw: Copper Alloy.
 Rivit: Fe. &. Copper Alloy.

Note:

No	A	B	C
09	16.92	24.99	30.81
15	25.25	33.32	39.14
25	38.96	47.04	53.04
37	55.42	63.50	69.32

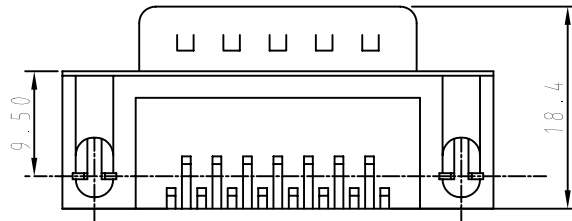

PART NO. DBxxM0101K00-S1E

Contact Gold Plating:
 00: Selective Gold Flash
 G0: Full Gold Flash

Mounting and Screws Options
 S1: Fixed UNC#4-40 Screws and Board Locks
 S2: #4-40 Thread Rivet with Board Locks, Screws Attached Separately
 S3: #4-40 Thread Rivet with Board Locks, without Screws

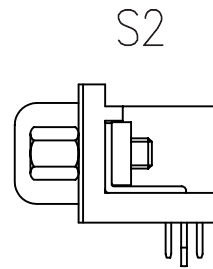
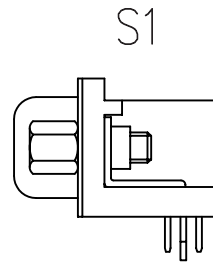
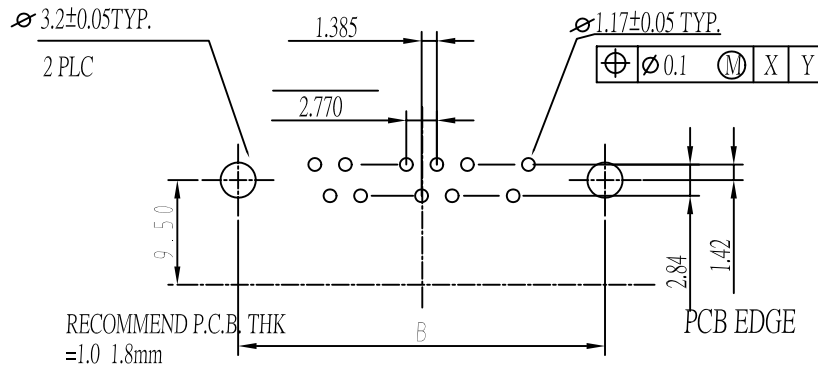

DWG NO:		MATERIAL:		PANSTRONG COMPANY LTD.
MODEL NO:		FINSH:		
UNIT: mm	SIZE:	COLOR:		PART NAME: D-SUB Male 90D/7.2
TOLERANCE UNSPECIFIED		DR: TOMMY		PART NO: DB xxM0101K00-S1E
.x	±0.3	CHK:		REV:
.xx	±0.20	APP:		SCALE: 1.5:1
.xxx	±0.100			SHEET: 1 of 1
ANG.	±1°			