

REV	DESCRIPTION	DATE
A	Initial Release	03'.07.28

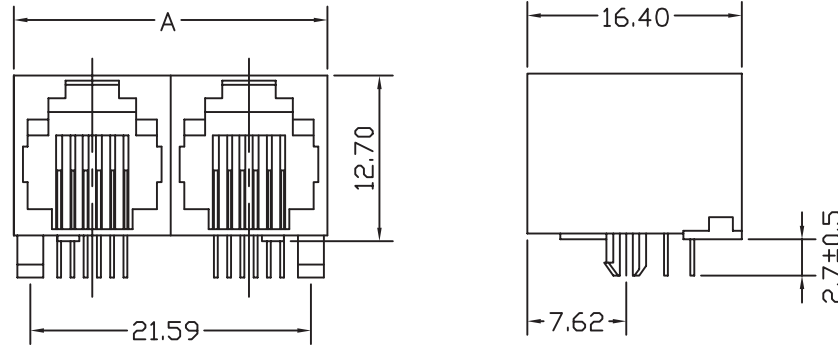

SPECIFICATIONS

MATERIAL:

1. Housing : PBT Polyester UL94V0
2. Color : Black
3. Contacts : 0.35mm Thickness Alloy Selective Gold Plating

ELECTRICAL:

1. Current Rating : 1.5 AMP MAX
2. Voltage Rating : 150 VAC MAX
3. Contact Resistance : 30 milliohms MAX, initial
4. Insulation Resistance : 500 Megohms MIN
5. Dielectric Withstanding Voltage : 1000 VAC, 1min

Part No. MJL2-660101Kxx-2

Contact Gold Plating:
06: 6u" Selective Gold
:
50: 50u" Selective Gold

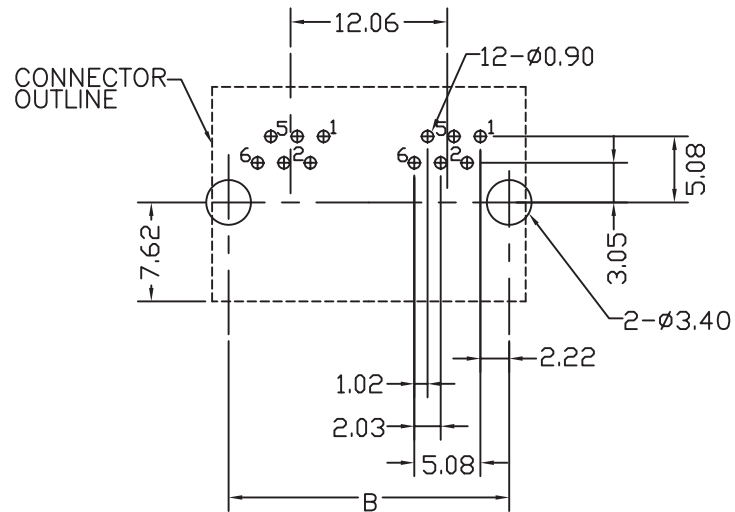

PCB LAYOUT/TOP VIEW

Ports	Dimensions m/m	
	A	B
1	12.10	9.53
2	24.20	21.59

TOLERANCE	
.X	±0.3
.XX	±0.20

PANSTRONG COMPANY LTD.				DRAWN BY		TOMMY	
				CHECKED			
TITLE:		6P Side Entry Modular Jack		APPROVED			
PART NO:		MJL2-660101Kxx-2		DRAW NO			
File Number:				UNIT		mm	
SCALE		Free	REV	A			