

7	8	9	10	11
REV	DESCRIPTION			DATE
B	Initial Release			05.1026

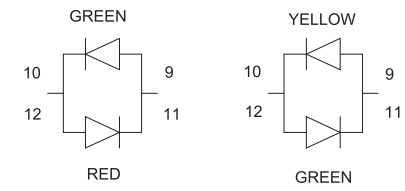

BI-COLOUR LED DETAIL
(GREEN/RED AND YELLOW/GREEN LED'S ARE ALSO AVAILABLE)

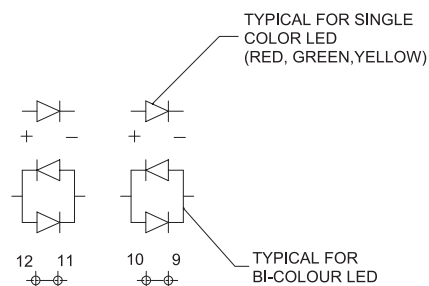
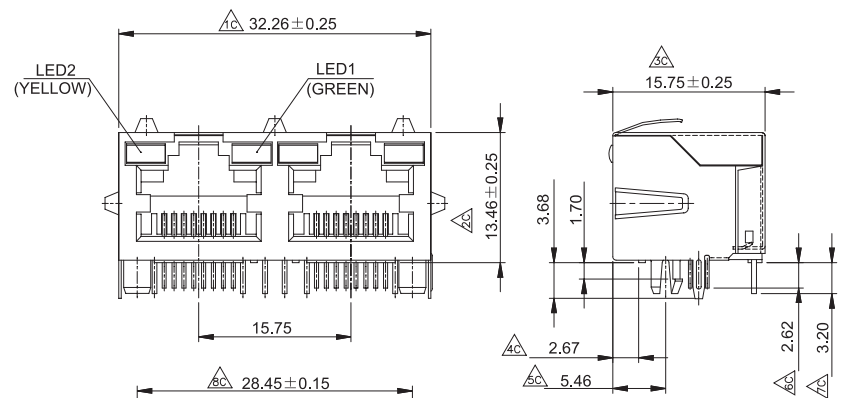
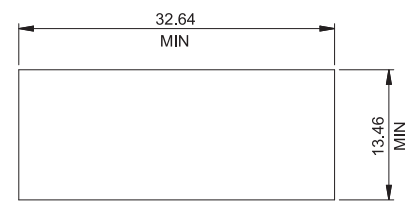
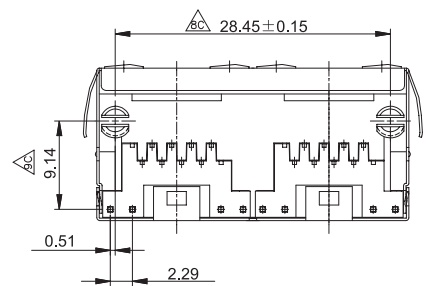

RECOMMENDED PANEL CUTOUT

MATERIALS:
PLASTIC HOUSING: ENGINEERING THERMOPLASTIC
 FLAMMABILITY RATING UL 94V-0.
CONTACTS: PHOSPHOR BRONZE
PLATING: GOLD PLATING OVER NICKEL IN CONTACT,
 TIN PLATING OVER NICKEL IN SOLDER AREA.
SHIELD: BRASS PLATING NICKEL ALLOY.

PART NO : MJSD-GY01Kxx-2T3

LED COLOR OPTINO | Contact Gold Plating
 LED 1/LED 2 | 06: 6u" Selective Gold
 GY:Green/Yellow | 15: 15u" Selective Gold
 GR:Green/Red | 30: 30u" Selective Gold
 BB:Bi-Color Green Yellow
 for both LEDs

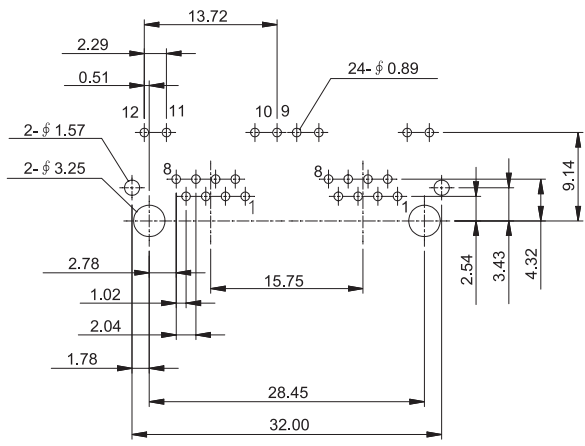

P.C.B LAYOUT/TOP VIEWS

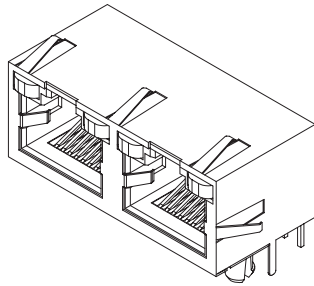

PANSTRONG COMPANY LTD.				DRAWN BY		TOMMY	
				CHECKED			
TITLE:		3046 2PORT 8P8C JACK W/LED(Y-G)		APPROVED			
PART NO:		MJSD-xx 01Kxx-2T3		DRAW NO			
DRAW. BOX NO:							
SCALE	2:1	REV	B	UNIT	mm		