

REV	DESCRIPTION	DATE
A	Initial Release	07.10.11

MATERIALS:  
 PLASTIC HOUSING: HIGH TEMP. THERMOPLASTIC  
 FLAMMABILITY RATING UL 94V-0.  
 CONTACTS: PHOSPHOR BRONZE  
 PLATING: GOLD PLATING OVER NICKEL IN CONTACT.  
 TIN PLATING OVER NICKEL IN SOLDER AREA.

PART NO.  
 MJ880302Kxx-MS2R

Contact Gold Plating  
 06: 6u"  
 15: 15u"  
 30: 30u"  
 50: 50u"

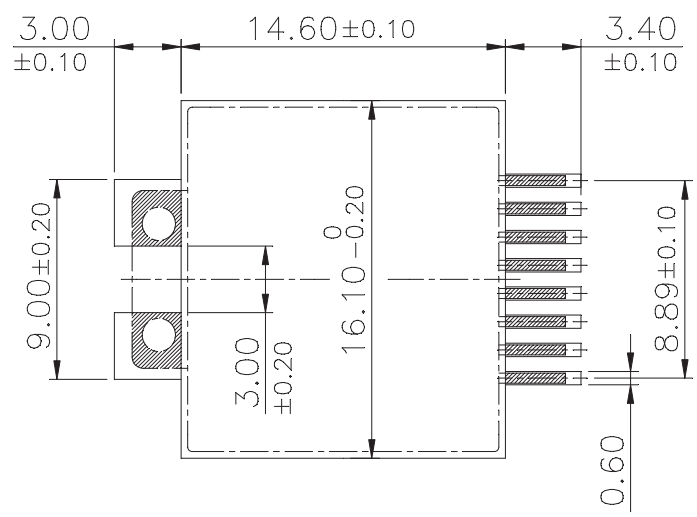
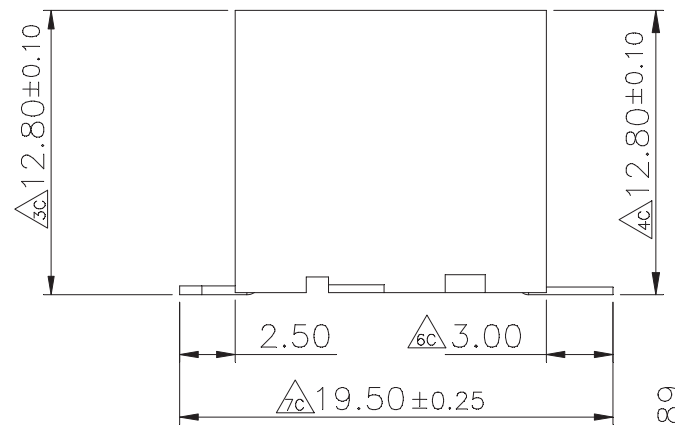
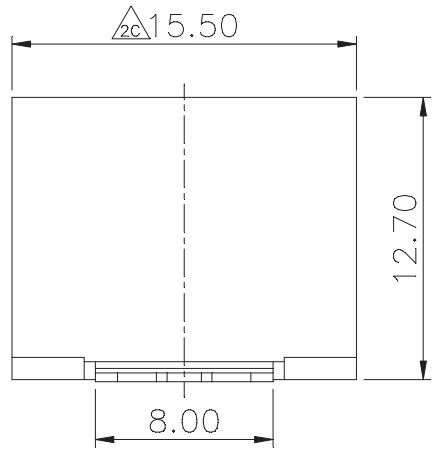

PCB LAYOUT/TOP VIEW

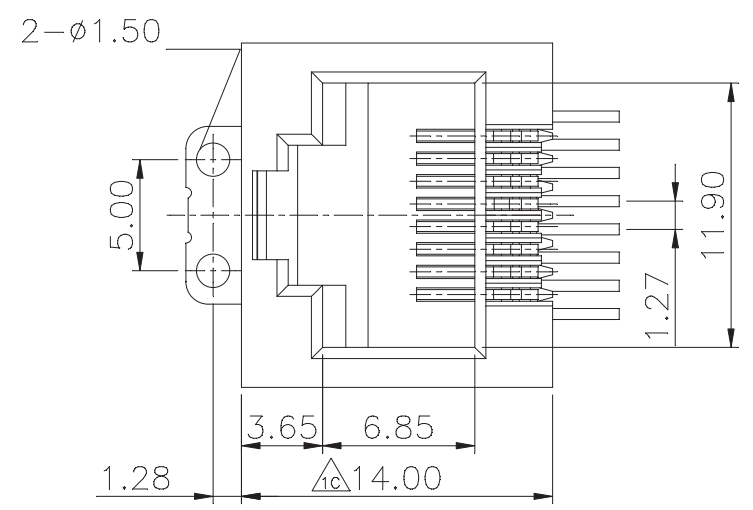
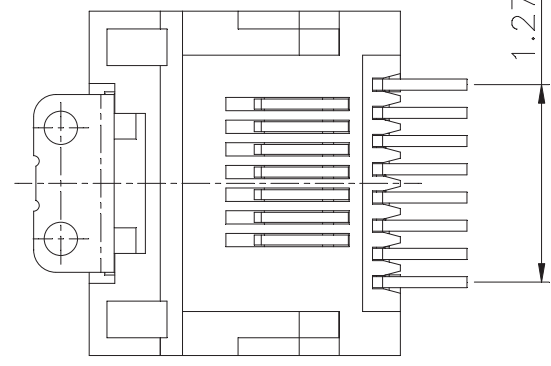

※ △: Q.C. Dimensions

RoHS COMPLIANT

TOLERANCE	
.XXX	±0.10
.XX	±0.25
.X	±0.38
X	±0.50
ANG	±3°

PANSTRONG COMPANY LTD.				DRAWN BY		TOMMY	
				CHECKED			
TITLE:		TOP ENTRY SMT JACK(8P8C)				APPROVED	
PART NO:		MJ880302Kxx-MS2R				DRAW NO	
File Number:							
SCALE	3:1	REV	A	UNIT	mm		