

REV	DESCRIPTION	DATE
A	Initial Release	05'.11.09

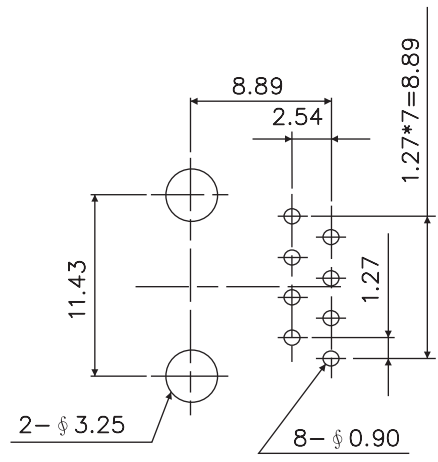
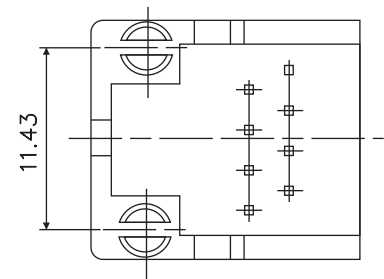
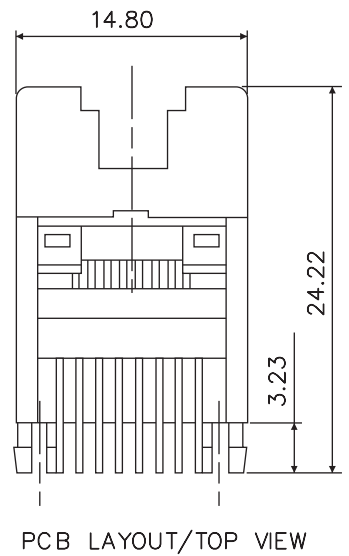
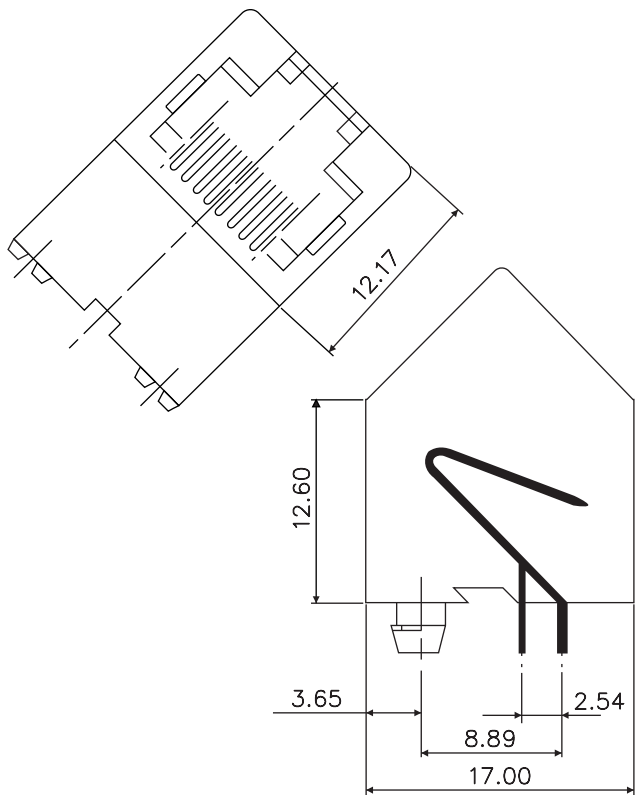

- ELECTRICAL:**
- VOLTAGE RATING 125 VAC RNS
 - CURRENT RATING 15 AMP
 - CONTACT RESISTANCE 50 MILLIOHMS MAX.
 - INSULATION RESISTANCE 1000 MEGOHMS MIN @ 500 VDC
 - DIELECTRIC STRENGTH 1000 VAC RNS 60Hz MIN.
- MECHANICAL:**
- HOUSING MATERIAL: GLASS FILLED POLYESTER UL94V-0
 - CONTACT MATERIAL: PHOSPHOR BRONZE 0.46mm
 - PLATING: 1.CONTACT AREA SELECTIVE GOLD PLATING
2.TAILS 150u" TIN-LEAD MIN OVER 50u" NICKEL
 - OPERATING LIFE: 750 CYCLES MIN.
 - PCB RETENTION PRE-SOLDER 1 LB MIN.
 - PCB RETENTION POST-SOLDER 10 LBS MIN.
- ENVIRONMENTAL:**
- STORAGE: -40 TO +85 DEGREE
 - OPERATION: 0 TO 70 DEGREE

MATERIALS:
 HOUSING: GALSS FILLED POLYSTER UL94V0
 STANDARD COLOR(WHITE)
 CONTACT: 0.35mm Alloy C5210
 Selective Gold Plating

PART NO. MJ - 8 8 01 05 W 06

No. of Position — 8
 No. of Contact — 8
 Thru-Hole Soldering — 01

05 — Gold Plating
 6u", 15u", 30u", 50u"
 W: White Color
 45 Deg Entry

PANSTRONG COMPANY LTD.				DRAWN BY		TOMMY	
				CHECKED			
TITLE:		Modular Jack 8/8 45 Degree Entry				APPROVED	
PART NO:		MJ8845Deg Unshielded				DRAW NO	
File Number:							
SCALE	2.5:1	REV	A	UNIT	mm		