

REV	DESCRIPTION	DATE
A	Initial Release	20.07.13

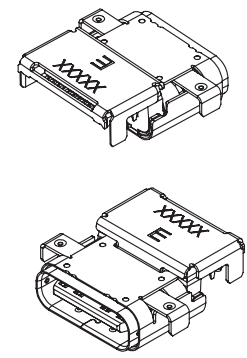
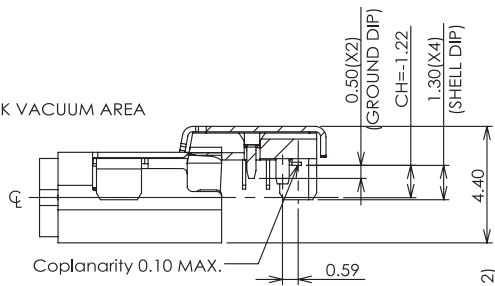
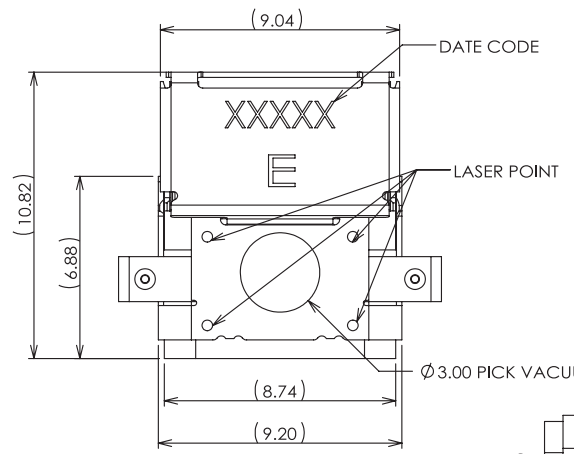

- NOTES
- ELECTRICAL CHARACTERISTICS
 - LOW LEVEL CONTACT RESISTANCE
INITIAL 40m FOR ALL CONTACT MAXIMUM.
AFTER TEST: 50m
 - DIELECTRIC WITHSTANDING VOLTAGE:
100V AC FOR 1 MINUTE SEA LEVEL
 - INSULATION RESISTANCE:
100M
 - CURRENT RATING:
VBUS AND GND CONTACTS RATED AT 1.25A EA.
PARALLEL FOR A TOTAL OF 5A
 - MECHANICAL CHARACTERISTICS:
 - INSERTION FORCE: 1~10000 CYCLES 5N~20N
 - EXTRACTION FORCE:
INITIAL EXTRACTION FORCE 6TH CYCLES OF 8N ~ 20 N
1~5 INSERTION/EXTRACTION PRECONDITIONING CYCLES
DURABILITY 32TH EXTRACTION FORCE SHALL BE 33% OF THE INITIAL
READING AND WITHIN THE RANGE 8 N ~ 20 N.
(6 CYCLES ADDITIONAL 25 INSERTION/EXTRACTION CYCLES)
AFTER DURABILITY 10,000 CYCLES OF 6N ~ 20N
 - DURABILITY: 10,000 CYCLES.
 - OPERATING TEMPERATURE: -55°C TO +85°C

PART NO.
UB40CR31LB2-24 F K xx x
1 23 4 5

- Contact Positions:
24: 24 Pins
- Contact Type:
F: Female Receptacle
- Insulator Color:
K: Black
- Contact Plating:
30: 30u" Selective Gold
- Shell Plating:
N: Soldering Nicke

ITEM	NAME	Q'TY	MATERIAL / FINISH
5	OUTER SHELL	1	METAL / Ni PLATED
4	SHELL	1	METAL / Ni PLATED
3	GROUND PLATE	1	METAL / Ni PLATED
2	CONTACT	24	COPPER ALLOY / Au PLATED
1	HALF PRODUCT	1	HI-TEMP / UL94v-0

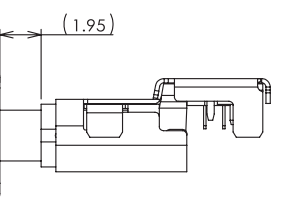
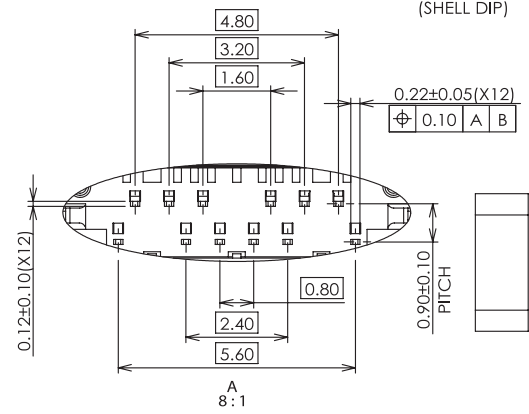
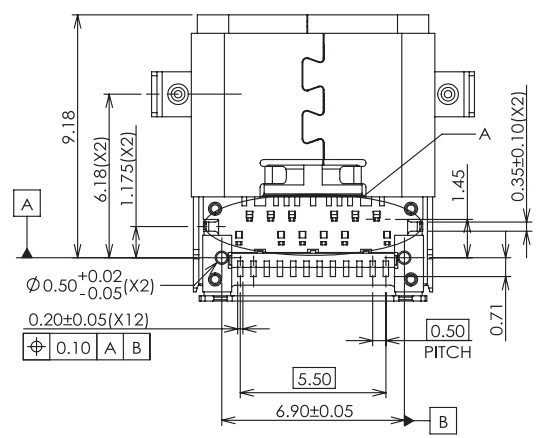
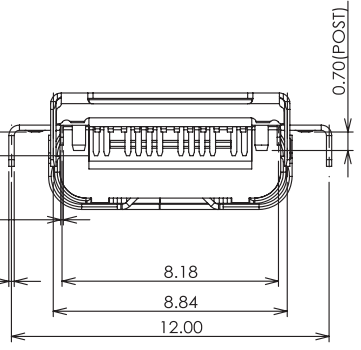
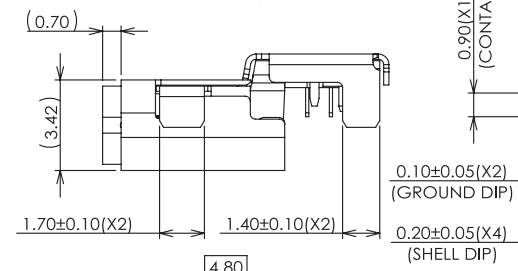
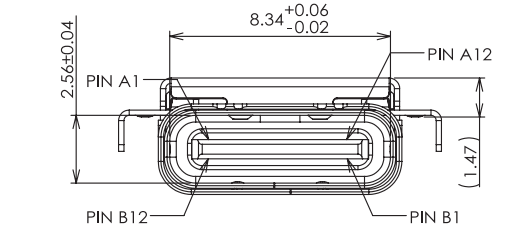

PIN NO.	~	~	A1	A2	A3	A4	A5	A6	A7	A8	A9	A10	A11	A12
SIGNAL NAME	~	~	GND	SSTXp1	SSTXn1	VBUS	CC1	Dp1	Dn1	SBU1	VBUS	SSRXn2	SSRXp2	GND
PIN NO.	C2	C1	B12	B11	B10	B9	B8	B7	B6	B5	B4	B3	B2	B1
SIGNAL NAME	GND	GND	GND	SSRXp1	SSRXn1	VBUS	SBU2	Dn2	Dp2	CC2	VBUS	SSTXn2	SSTXp2	GND

TOLERANCES UNLESS OTHERWISE SPECIFIED
 GENERAL: X ±0.38
 X ±0.25
 XX ±0.13
 XXX ±0.05
 XXX ±0.03
 X° 25.0°
 XX° 27.0°
 XX° 41.0°

		DRAWN BY	TOMMY	
		CHECKED	TOMMY	
TITLE:	USB TYEP-C(USB4) CONN. RECEPTACLE MID MOUNT CH=1.22		APPROVED	CAROL
PART NO:	UB40CR31LB2-24FK		DRAWING NO.	
SCALE	/	REV	A	UNIT mm

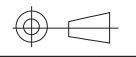

REV A	DESCRIPTION Initial Release	DATE 20.07.13
----------	--------------------------------	------------------

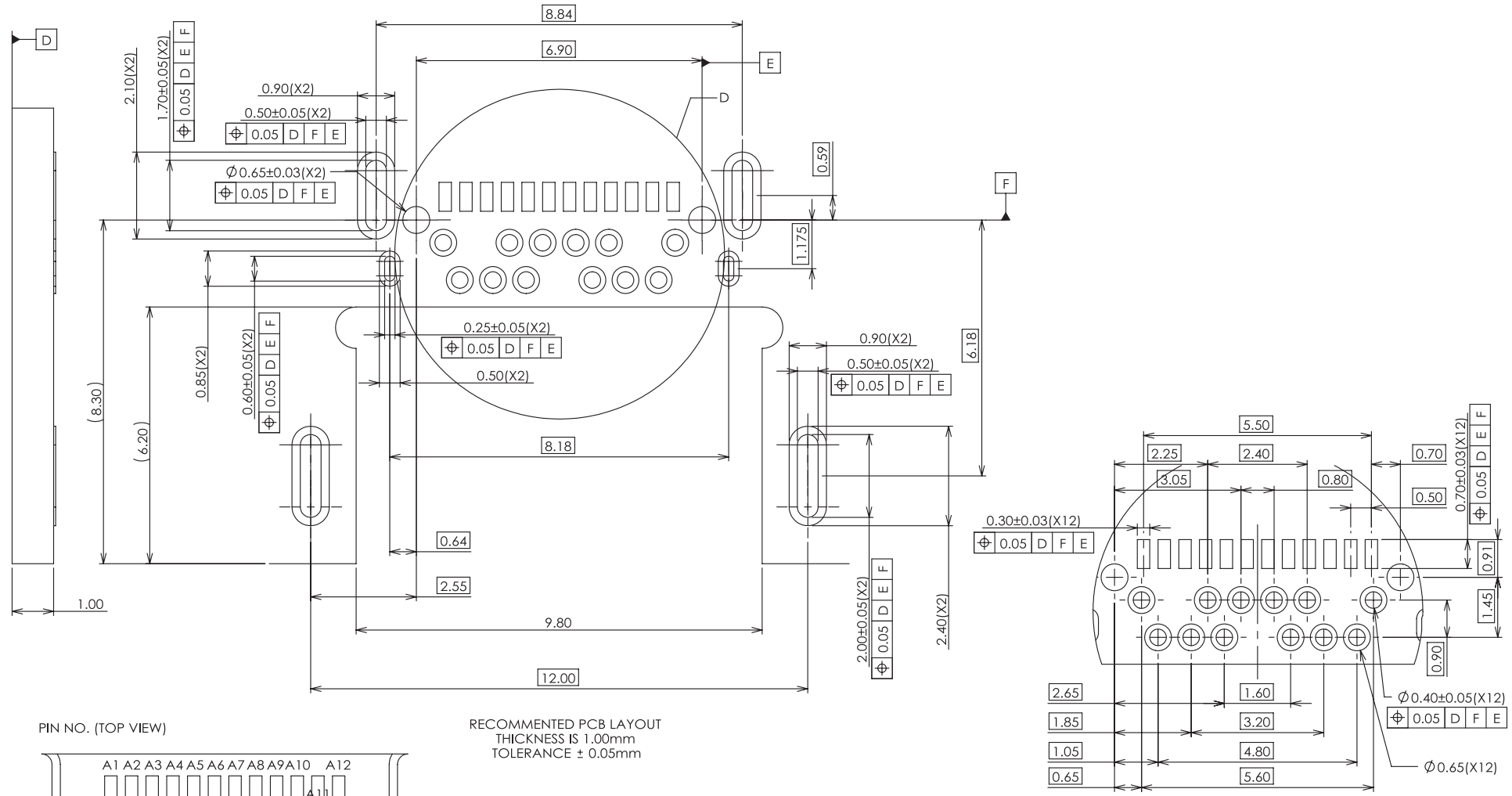

				DRAWN BY		TOMMY
				CHECKED		TOMMY
TITLE:		USB TYPE-C(USB4) CONN. RECEPTACLE MID MOUNT CH=1.22		APPROVED		CAROL
PART NO:		UB40CR31LB2-24FK		DRAWING NO.		
SCALE		/	REV	A	UNIT	mm

TOLERANCES UNLESS OTHERWISE SPECIFIED

GENERAL	X	±0.38
	X	±0.25
	XX	±0.13
	XXX	±0.05
ANGLES	X	±30°
	X*	±2°
	XX*	±1.0°