

REV	DESCRIPTION	APPROVAL	DATE
A	Initial Release		06'.05.06

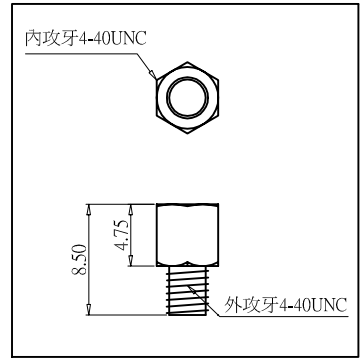
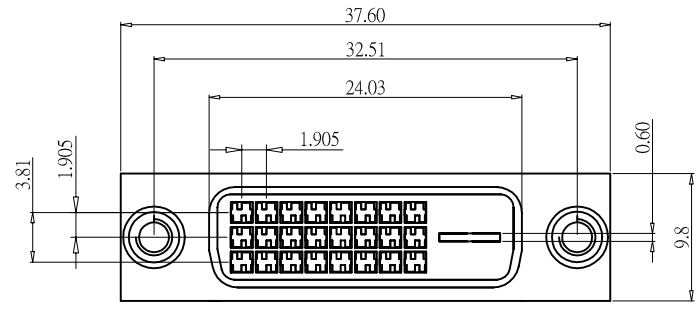

**\*MATERIAL**  
 BODY : PA66+30% UL 94V-0 RATED, COLOR: WHITE  
 CONTACTS : BRASS  
 CONTACT PLATING : GOLD PLATING OVER NICKEL ON CONTACT AREA TIN PLATING ON TERMINAL

**\*MECHANICAL**  
 MATING FORCE : 4.5 KG MAX. @ 25 MM/MINUTE  
 UNMATING FORCE: 1.0 KG MIN. AND 4.0 KG MAX. @25 MM/MINUTE  
 DURABILITY: 100 MATING CYCLES

**\*ELECTRICAL SPECIFICATION**  
 INSULATION RESISTANCE : 1000 MEGOHMS MIN  
 DIELECTRIC WITHSTANDING VOLTAGE : 500 V DC RMS ±50 V.60 HZ  
 CURRENT RATING: 1.5 AMPERES MIN  
 SHELL RESISTANCE: 50 MILIOHMS MAX.INITIAL;50 MILIOHMS MAX.CHANGE FROM INITAL  
 CONTOCT RESISTANCE : 20 MILLOHMS MAX.

**\*ENVIRONMENTAL**  
 OPERRATING TEMPERATURE : -20°TO85°

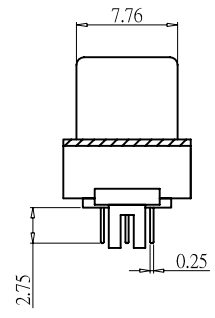
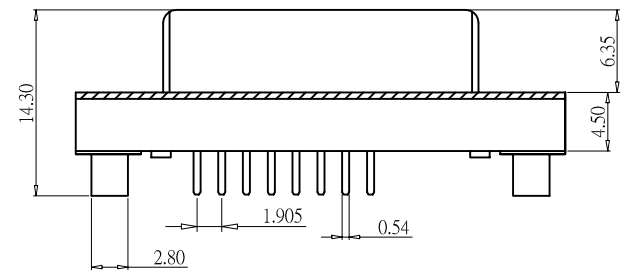

**\*HOW TO ORDER**  
 PART NUMBER:  
 DV 24 F 01 02 W 01 B  
 (1)(2)(3)(4)(5)(6)(7)

(1)PIN NUMBER  
 24:24+0  
 25:24+1

(2)F:Female Receptacle.  
 (3)01:Through-Hole, Solder for PCB  
 (4)01:Right Angle/Side Entry  
 02:Vertical/Top Entry  
 (5)Insulator Color  
 K:Black  
 W:White  
 (6)Gold Plating on Contacts  
 01:Gold Flash  
 (7)Blank:Without Screws  
 A:with Fix Nut Screws  
 B:with Screws Attached Separately

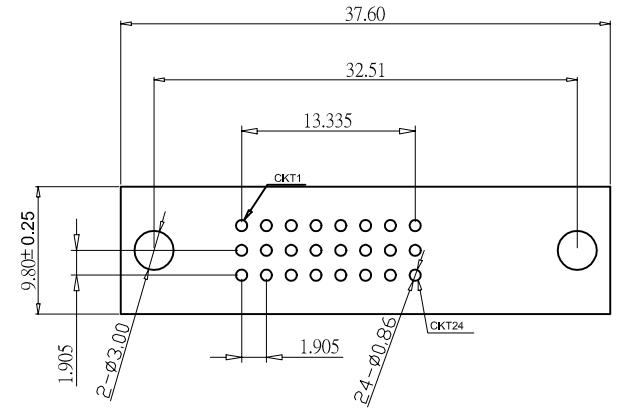

P.C.B LAYOUT

**METRIC**  
 .0=±0.35  
 .00=±0.25  
 .000=±0.15

				DRAWN BY		TOMMY	
				CHECKED			
TITLE:		DVI(24+0)F 180 ° 附4.75x8.50		APPROVED			
PART NO:		DV24F0102W01B		DRAW NO			
File Number:				UNIT		mm	
SCALE	1:1	REV	A				